



Counselor Conference 2017 Directions for Attendees*

INDEX

September 5-San Diego, see page 1

September 6 & 7-Riverside, see page 2

September 8-Los Angeles, see page 3 (note the directions by track)

September 11-Santa Cruz at Santa Clara Convention Center, see pages 4-5

September 12-Davis at Sacramento Convention Center, see pages 6-9

***All events are at capacity and no “walk-in registrations” will be accepted.**

SAN DIEGO – September 5, 2017

Parking & Check-In

Parking is complimentary in the Hopkins Parking Structure (see driving directions). Inform the parking attendant that you are here for the UC Counselor Conference and need a parking pass.

Check-in and refreshments will be at Library Walk.

Directions

Exit at either La Jolla Village Drive (Exit 28) or Genesee Ave. (Exit 29) and follow the signs to the Hopkins Parking Structure.

For directions to UC San Diego and a campus map go to: <http://act.ucsd.edu/maps/>



RIVERSIDE – September 6, 2017 & September 7, 2017 (2 DAYS) at the Highlander Union Building (HUB) on the UC Riverside campus

Parking and Check-in

Please exit University Avenue. Once you arrive on campus, please follow the signs directing you to **Lot 30**.

Driving Directions

Directions to UC Riverside and campus maps can be found at the website: <http://www.ucr.edu/about/directions.html>.

Check In

Check-in will take place in front of the Highlander Union Building in HUB Upper Plaza, by the Coffee Bean and Tea Leaf.



LOS ANGELES – September 8, 2017

Parking

Conference participants should park in Parking Structure 3. **Parking permits will be available for \$12.** Parking attendants will be available from 7:00 a.m. to 10:00 a.m. at the east and west entrances of the structure. **Please note only cash payments will be accepted at the entrances.**

If you arrive before 6:00 a.m. or after 10:00 a.m., please proceed to the Parking Information Booth located on Westwood Blvd and Strathmore Avenue. Inform the attendant that you are here for the UC Counselor Conference and they will provide you with a parking permit and direct you to Parking Structure 3.

In order to avoid a parking citation please do not enter the parking structure prior to getting a parking permit.

Check-In for COMMUNITY COLLEGE TRACK

Check-in for community college participants will take place at the Campbell Hall Patio (located in between Campbell Hall and Rolfe Hall). Please look for signs and staff in blue polos that will direct you to Campbell Hall Patio.

Check-In For HIGH SCHOOL TRACK

Check-in for high school participants will take place at Briskin Family Plaza, located adjacent to Rolfe Hall and Entrepreneurs Hall (UCLA Anderson). Please look for signs and staff in blue polos that will direct you to Briskin Family Plaza.

Driving Directions- https://main.transportation.ucla.edu/getting-to-ucla/directions-to-ucla?_ga=2.213480596.1699531325.1503414807-1859650338.1439189120

We encourage you to allow ample time for Los Angeles traffic and parking.

Campus Map- http://maps.ucla.edu/downloads/pdf/UCLA_Campus_Colored_Map.pdf



SANTA CRUZ at the Santa Clara Convention Center – September 11th, 2017

Driving Directions can be found [here](https://santaclaraconventioncenter.org/parking-directions/): <https://santaclaraconventioncenter.org/parking-directions/>

Parking

Parking is complimentary for this year's conference.

Please plan to park in the 3-story parking garage on the Santa Clara Convention Center campus.

Due to limited parking availability, **we highly recommend that you carpool with your colleagues or take public transportation to the Convention Center**, and arrive early. This will help to ensure that all conference attendees are able to receive complimentary parking.

Light refreshments will be served in the morning and a boxed meal will be provided for lunch.

Please note that we **will not** be taking walk on registrations (please do not bring colleagues with you for last minute registration). Also, names of participants cannot be changed at the conference.

Please note the Santa Clara Convention Center site map on page 5 of this document.

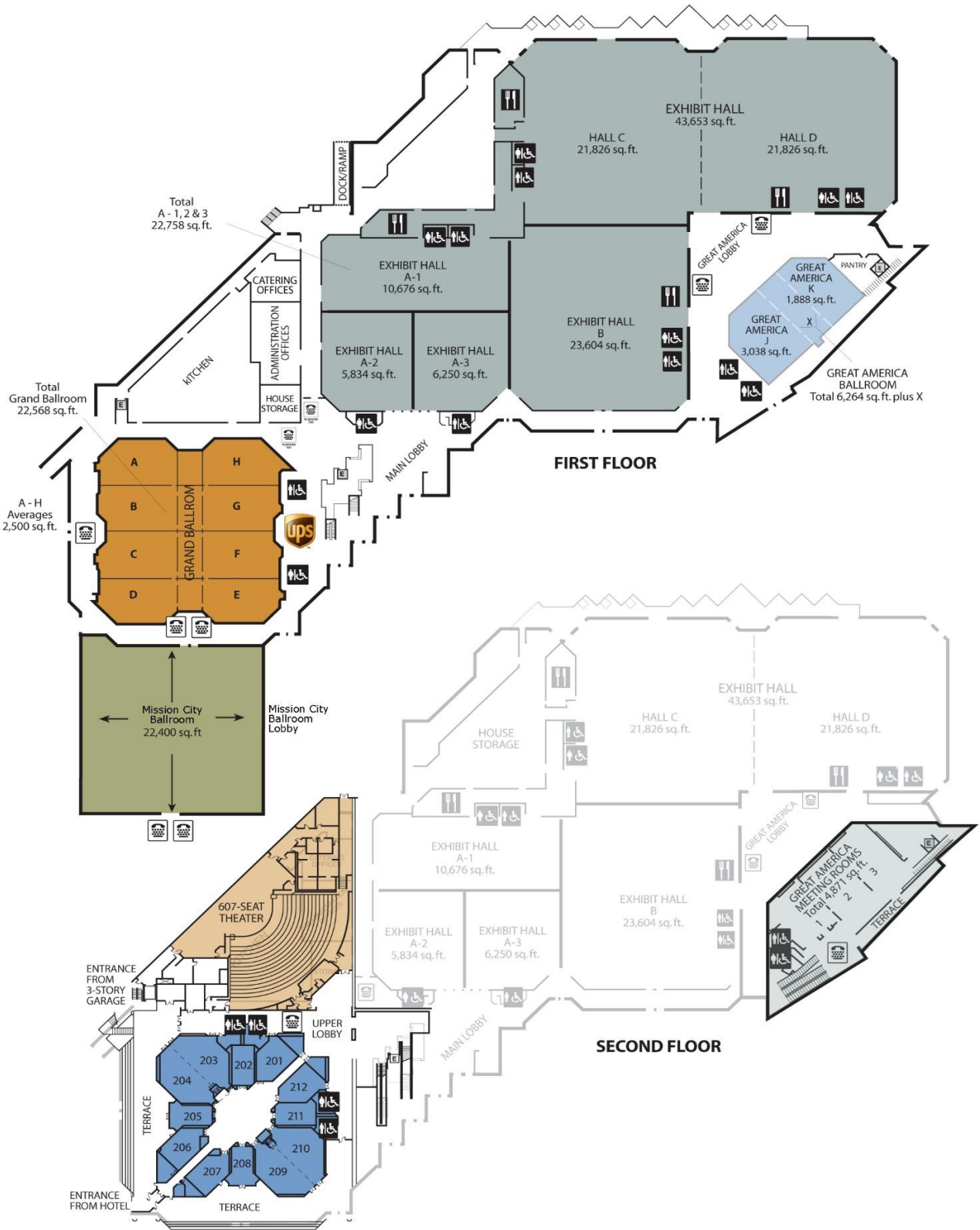

DAVIS at the Sacramento Convention Center – September 12th, 2017

Event Parking: Please keep in mind that you will have to pay for parking in Downtown Sacramento. Once parked, as you get closer to the venue you'll see blue and gold balloons letting you know you're heading in the right direction. Below are the following seven recommended parking garages/lots closest to the center (parking map and more lot details on pages 8 & 9):

	Lot Name & Cost	Address
1	Memorial Garage, Cost \$6	15th & H Street
2	Priority Parking, Cost \$10	1117 J Street
3	Sheridan Garage, Cost \$30	900 13th Street
4	Esquire Plaza Lot, Cost \$21	13th St. between J & K Streets
5	Priority Parking, Cost \$15	1414 I Street
6	Priority Parking, Cost \$10	1601 I Street
7	Central Parking, Cost \$24	1500 K Street

Guests/Attendees: Please be sure to check in at the East Lobby on the third floor of the Convention Center. Once checked in you can enjoy breakfast along with some light refreshments.

Directions to Convention Center:

FROM SAN FRANCISCO I-80 (DAVIS, VALLEJO, OAKLAND, SAN JOSE)-

Take I-80 East to Sacramento
 Continue on US -50 East Toward Sacramento/South Lake Tahoe
 Take I-5 Freeway (Redding turn-off)
 Take "J" Street Exit (one-way street, East)
 Take "J" Street to 14th Street
 Convention Center on right hand side

FROM RENO I-80 (ROSEVILLE, AUBURN)

Take I-80 West toward Sacramento
 Take I-5 South to Los Angeles
 Take "J" Street Exit (one-way street, East)
 Take "J" Street to 14th Street
 Convention Center on right hand side

Or

Take I-80 West to Sacramento
 Take Capitol City Freeway turn-off Business 80
 Take the "J" Street exit
 Bear left on 29th Street



Take a right on "L" Street

Take a right on 13th Street, Convention Center ½ a block on right hand side

FROM HWY 99 (ELK GROVE, STOCKTON, MODESTO, FRESNO)

Take Hwy 99 to Sacramento

Take US-50 towards San Francisco

Immediately get over to the right lane

Take 16th Street Exit (one-way street, North)

Take 16th Street to "I" Street (one-way street, West)

Take a left on "I" Street

Take a left on 14th Street

Convention Center on "J" Street and 14th Street

FROM SOUTH LAKE TAHOE HWY 50 (FOLSOM, PLACERVILLE)

Take Hwy 50 to Sacramento

Take 16th Street Exit (one-way street, North)

Take 16th Street to "I" Street (one-way street, West)

Take a left on "I" Street

Take a left on 14th Street

Convention Center on "J" Street and 14th Street

FROM I-5 NORTH (Natomas, Woodland, Yuba City) or SOUTH (Elk Grove)

Take "J" Street Exit (one-way street, East)

Take "J" Street to 14th Street

Convention Center on right hand side

Parking Lots near
Sacramento Convention Center
Memorial Auditorium & Community Theater



	Lot Name	Address	Phone #	Type of Lot	Approx. Space
1	Memorial Garage	15th & H Street	808-5110	10 Floor Tower	1,060
2	Priority Parking	1117 J Street	492-0100	Lot	75
3	Sheridan Garage	900 13th Street	441-5213	5 Floor Tower	800
4	Esquire Plaza Lot	13th St. between J & K Streets	498-9963	6 Floor Tower	
5	Priority Parking	1414 I Street	492-0100	Lot	100
6	Priority Parking	1601 I Street	492-0100	Lot	50
7	Central Parking	1500 K Street	530-344-3156	7 Floor Tower	520